



Applying Integrative Design to Outpatient Oncology: Is it the Right Approach?

DATE: January 29, 2018 PRESENTED BY: Patrick McCormick, Director, Ambulatory Oncology Programs & Clinics

Objectives

- Integrated health care design defined
- Understand the integrative design process
- Benefits of integrative design
- The results of integrated design



OHSU Knight Cancer Institute

- OHSU
 - Oregon's only academic medical center
 - 573 beds (adult and children's hospital)
 - 34K surgical cases
 - 894K ambulatory visits
- Knight Cancer Institute
 - NCI Comprehensive Cancer Center
 - 4,666 analytic cases (2016)
 - 58K office visits
 - 68K infusion visits
 - 237 BMT (2017)



Integrated Health Care Design

- The integration of Lean principles into the design process
- Design through the lens of the patient value stream
- Design that is reflective of the seven flows of health care:
 - Patient
 - Family and care givers
 - Healthcare personnel
 - Medications
 - Supplies
 - Equipment
 - Information



From Iterative to Integrated

- Rather than a back and forth process with architects, leverage the individuals who deliver the care in the design process.
- 9 Integrative Design Events:
 - Future patient value stream
 - Designing the clinic and infusion module
 - Designing the clinic and infusion room layout
 - Mock-up the design so you can get a better sense of the layout and flow



*The opportunity to design
a new health care space is
a great gift.*



The Challenge

Program:

- Design for the future when the crystal ball is not clear
- More programming than space allowed

Building:

- Urban area forced the requirement to build up
- OR/Procedure unit dictated some of the structural requirements
- Design regulations limited the size of the upper floors



The Result

- Knight Cancer Institute – 6 floors:
 - 2 exam floors (65 exam rooms)
 - Infusion floor (52 infusion positions)
 - Pharmacy and Early trials unit (11 positions; future)
 - 2 floors for faculty and clinical research offices
- Building – 14 floors:
 - 8 ORs and 10 Procedure rooms
 - 2 floors extended stay (48 rooms; 24 shelled)
 - 1 floor of clinics
 - 1 floor support systems (e.g. lab, sterile processing, etc.)

CHH2 and the Rood Family Pavilion



Clinic Floor



- Two clinic floors for a total of 65 exam rooms, 2 mammography, 2 ultrasound, 2 procedure suites

Women's Cancer Center and Multi-Discipline Clinic

Multi-Discipline
Clinic
Space

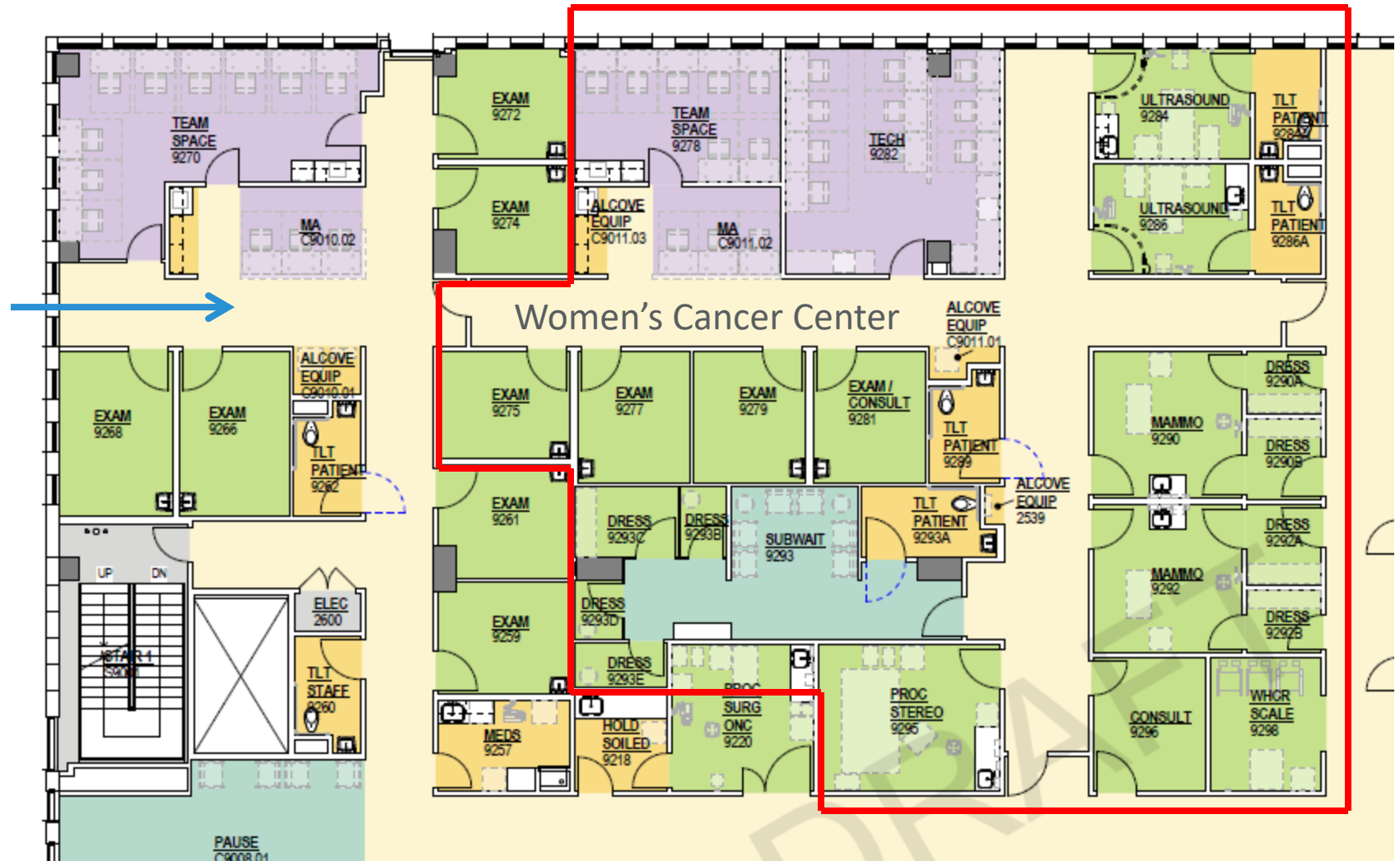

- Flexible multi-discipline clinic space allows for comprehensive breast cancer clinic to flex on clinic day and be used by other multi-discipline clinics on alternate days

Exam room mirrored pod

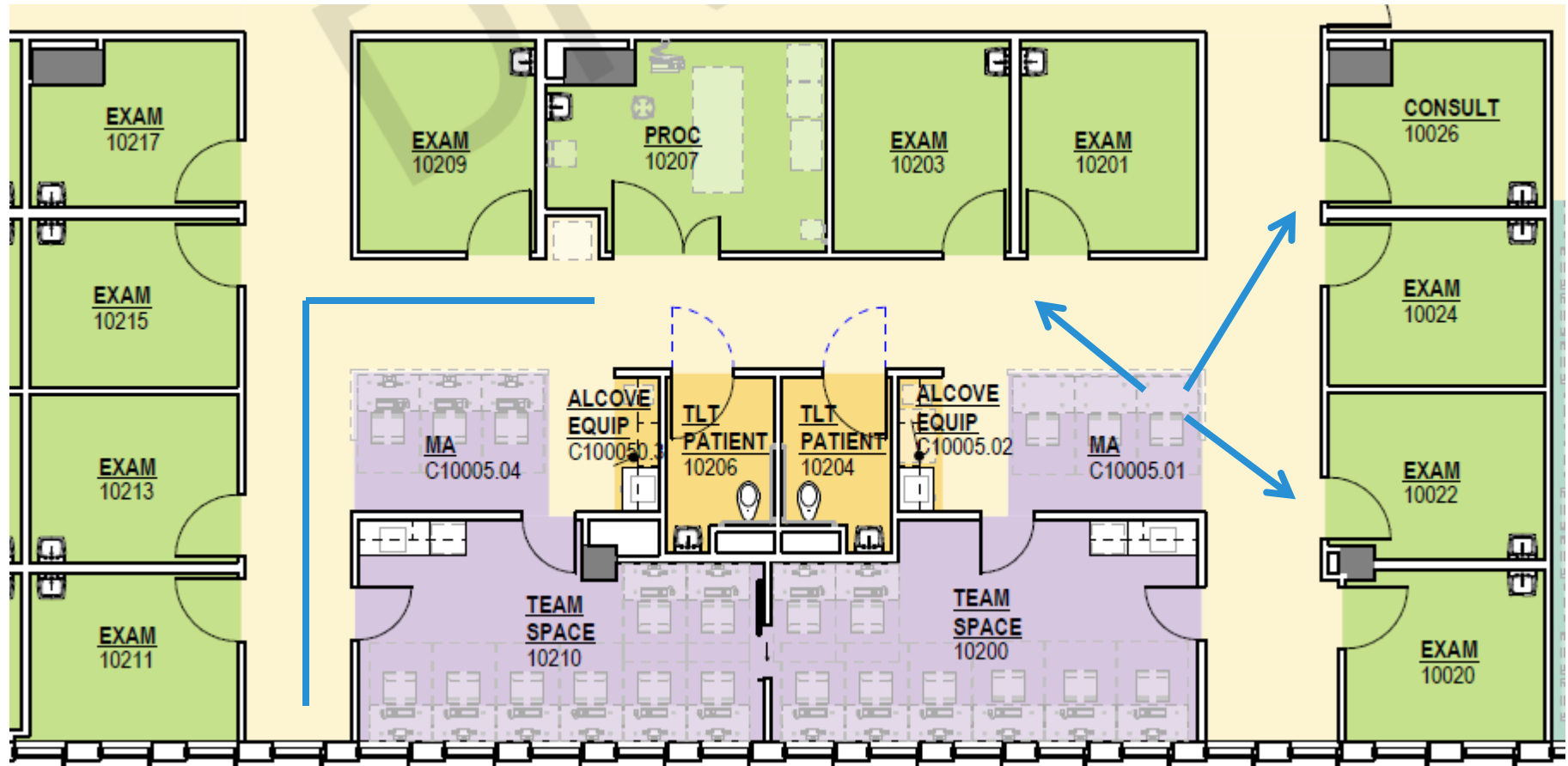

- L shaped pod replicated throughout the clinic floors
- Large provider work area, with lots of natural light that can flex to accommodate larger multi-discipline clinics
- MA work area with line of sight to exam rooms and access to provider work room

Infusion Unit



52 infusion positions: 17 private rooms, 20 semi-private infusion cubes, 10 open infusion bays, 5 fast track chairs



BMT and Acute Leuk Infusion Area

12 Infusion room unit imbedded in infusion floor. Closed off from rest of the floor. Patients come to this unit and all services come to the patient (blood draw, provider visit, infusion, procedures)



Flow of Medication

Chemo and drugs mixed one floor above are brought down via a lift and distributed to one of four med rooms imbedded in the infusion room pod

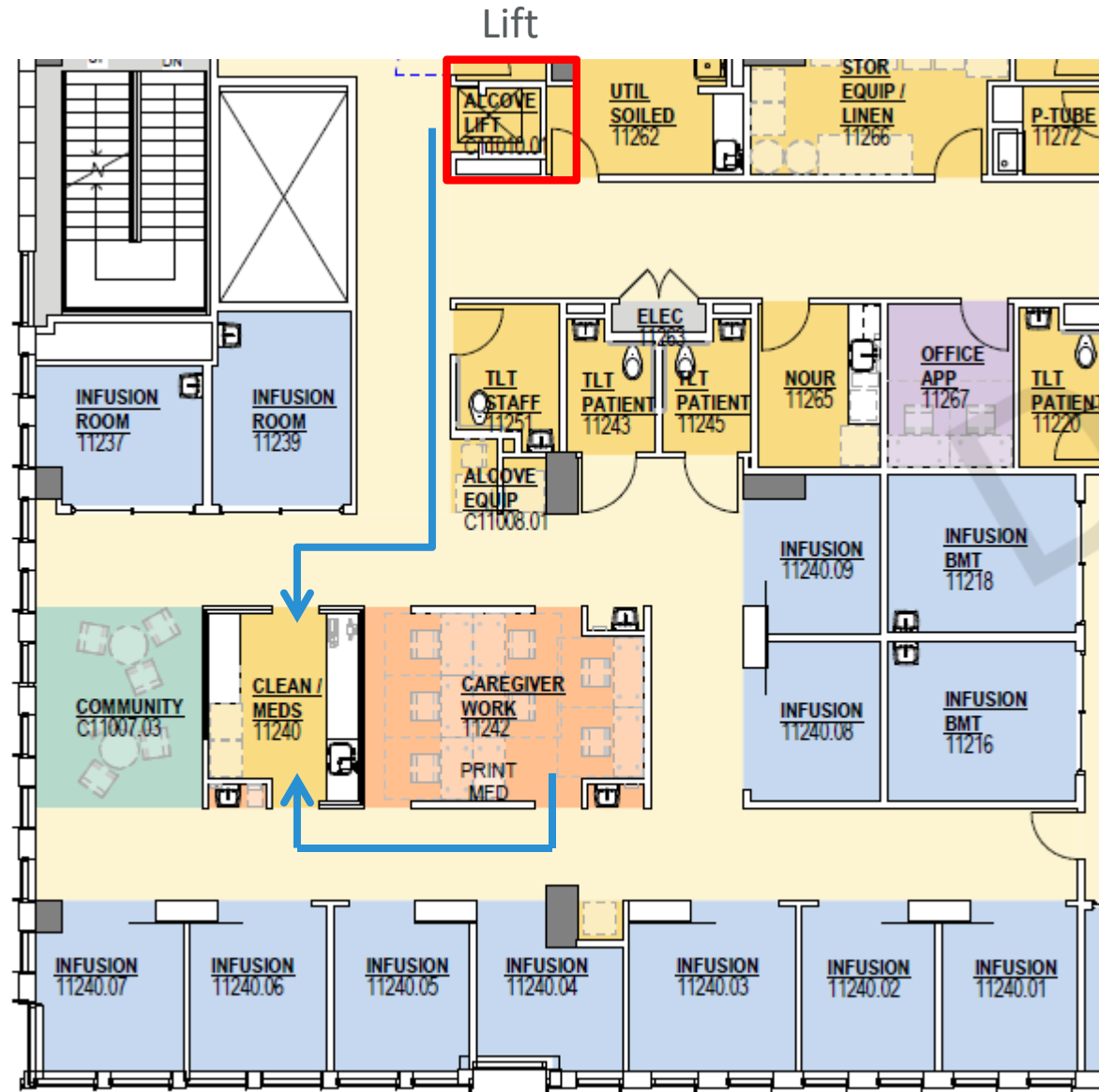

Integrative Design: Is it the right approach?

For the Knight Cancer Institute, yes!

Check back in 18 months to see if the answer is still the same...





Thank You